









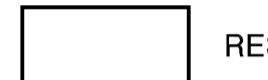

DESTINAZIONE D'USO DEL SUOLO E DEI FABBRICATI
CENTRO STORICO

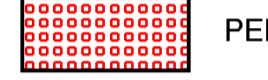
VARIANTE PUNTUALE n. 21 scala 1:500

Risognazione degli elaborati di PRG per
trasposizioni cartografiche di varianti
precedenti e modifiche di indicazioni
progettuali puntuali che non comportano nuova
edificazione o cambi di destinazione d'uso, ai
sensi dell'art.50, comma 4, lett. b) - L.N.458,
n°6185.

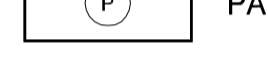
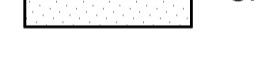
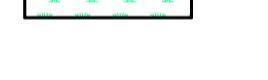
IL PROGETTISTA IL SINDACO IL SEGRETARIO

STUDIO ASSOCIATO ARCHITETTI NICOLA BALANI & MAURIZIO GUARIENTO
Via Don Nicola Musca, 21 - Vercelli - Tel. 045 8032722 - Tel/Fax 045 8002071
E-Mail: info@balaniguariento191.it

- LEGENDA
-  RESIDENZA E ATTIVITA' CONNESSE
 -  RESIDENZA TERZIARIO
 -  PERTINENZA (DELLA RESIDENZA, DELL'ATTIVITA' TERZIARIA, ECC.)
 -  MAGAZZINI E GARAGES
 -  ARTIGIANATO PRODUTTIVO
 -  SERVIZI PUBBLICI
 -  PARCHEGGI
 -  SPAZI CONNETTIVI PRIVATI
 -  VERDE PRIVATO
 -  AMBITO INSERIMENTO NUOVE COSTRUZIONI
 -  AMBITO P.R.
 -  ZONA F1 - PARCHEGGIO AD USO PUBBLICO

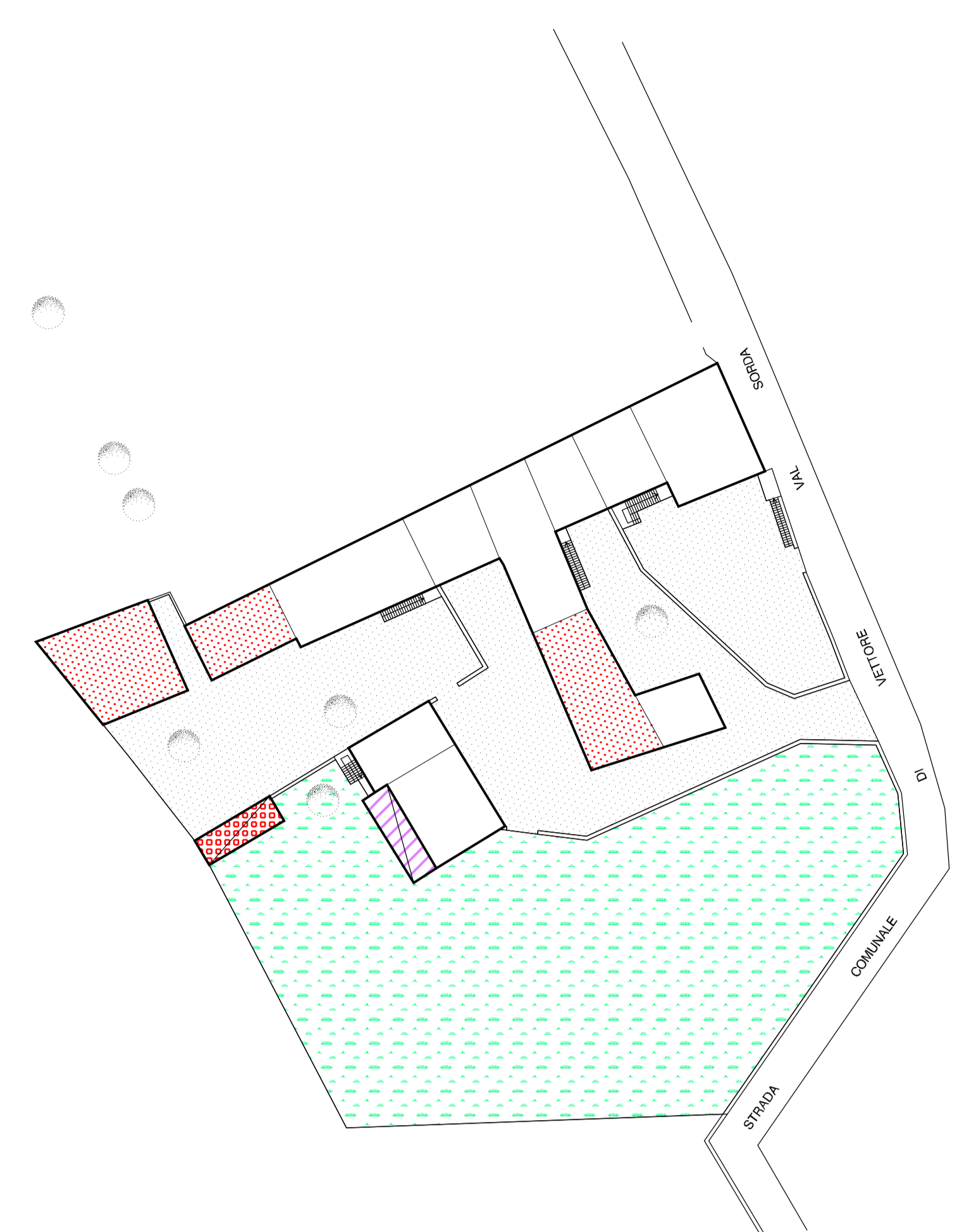

LA ROSCARA

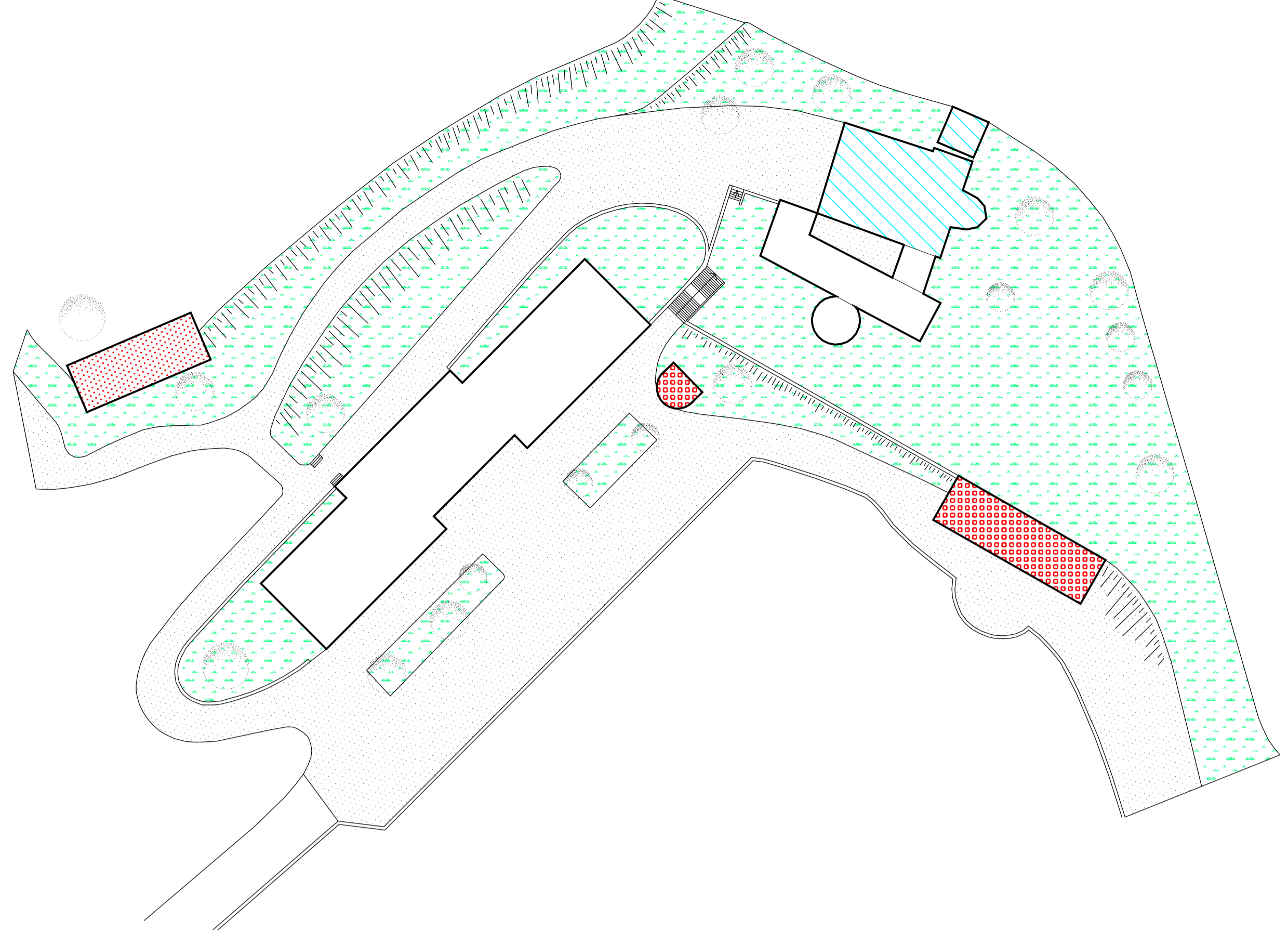

S. ANDREA



ARI

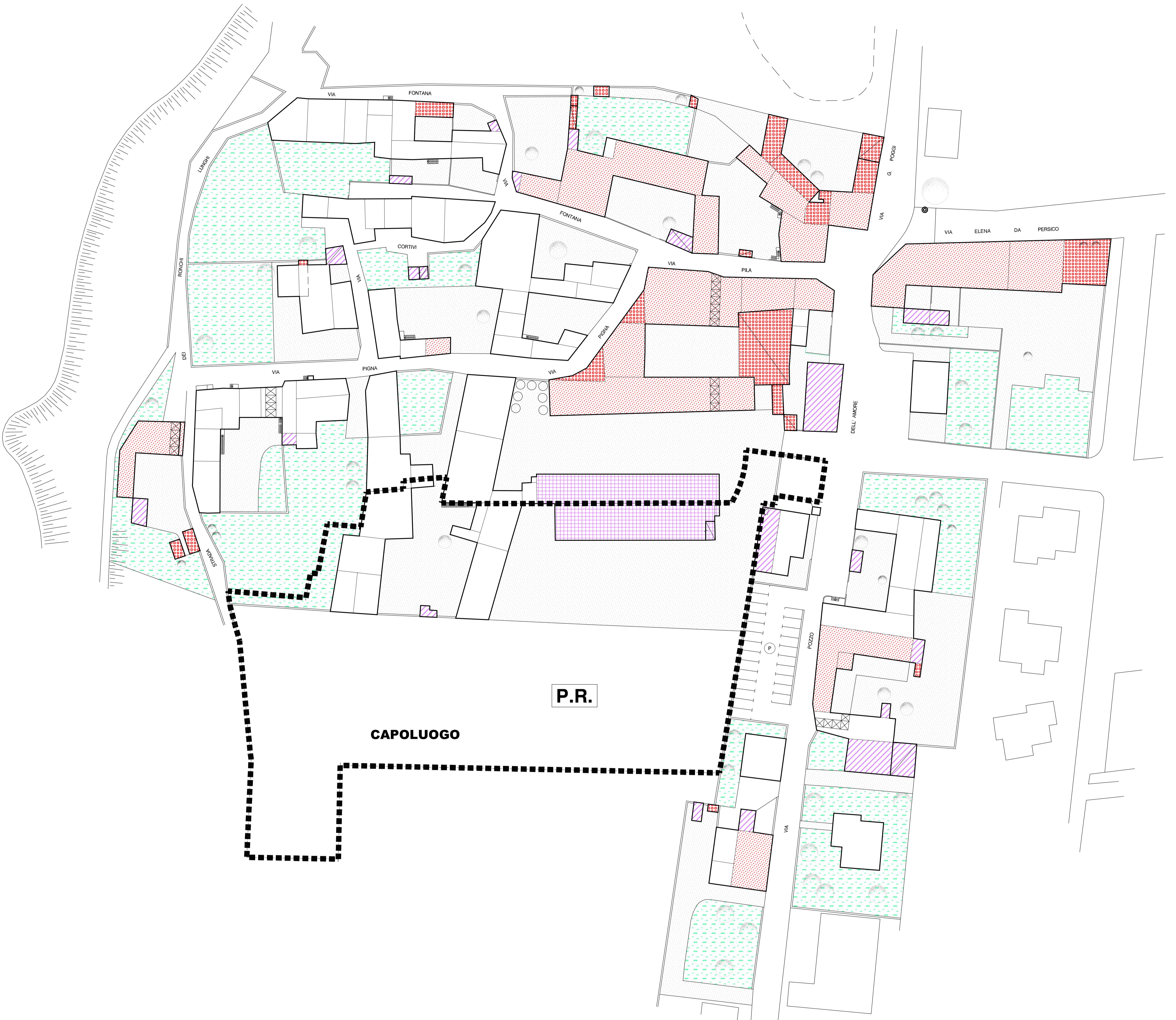

P.R.

CAPOLUOGO

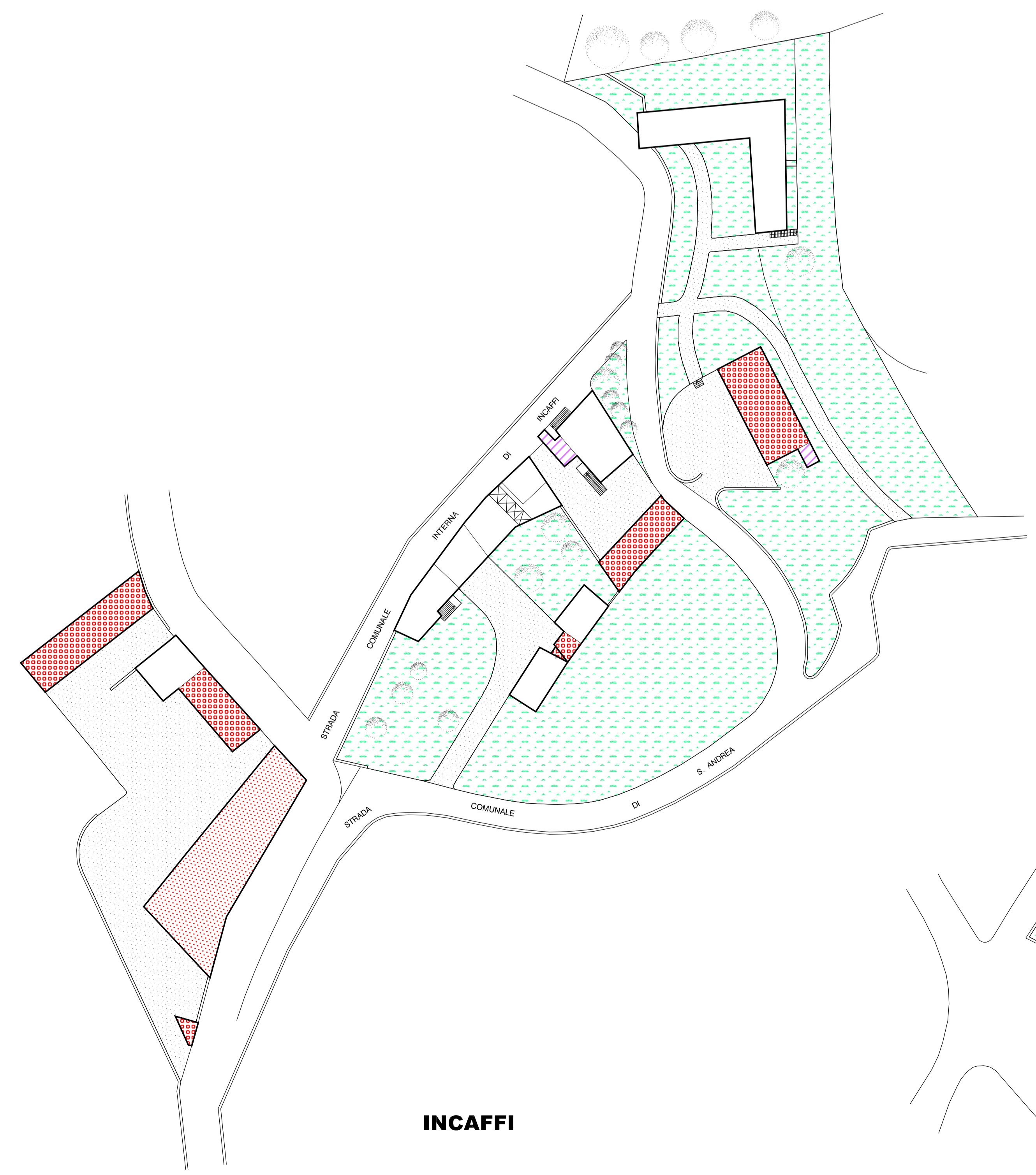

INCAFFI

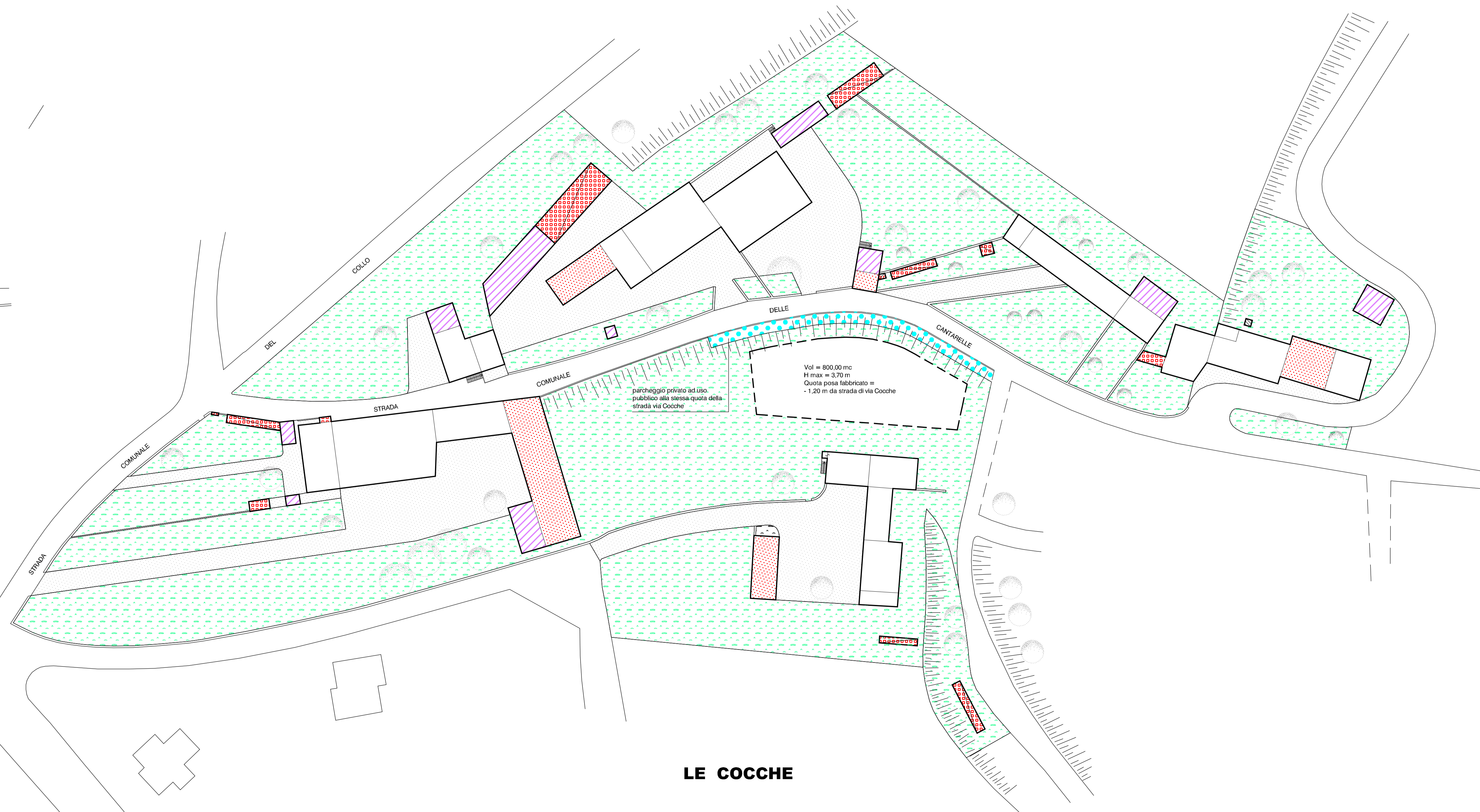

LE COCCHE



CA' ORSA